



The Bruce Freeman Rail Trail in Framingham



Hemenway School & Water St. Crossing

The 3.5-mile Framingham segment of the proposed 25-mile trail runs right through many of Nobscot's most populated neighborhoods. When completed, more than 1,000 residents will be within a 5-minute walk/bike of the trail.

Think of the rail trail as a 10-foot wide, paved linear park. This park will connect Framingham to 7 other communities to the north: Sudbury, Concord, Acton, Carlisle, Westford, Chelmsford and Lowell. This park will truly become a local and regional community asset offering safe, year-round family recreational activities.

When connected to the 5 existing and potential trails in MetroWest, the system created will offer a safe transportation alternative for commuters, tourists, and explorers from Framingham to Lowell, Milford, Marlborough, Boston and Cambridge.

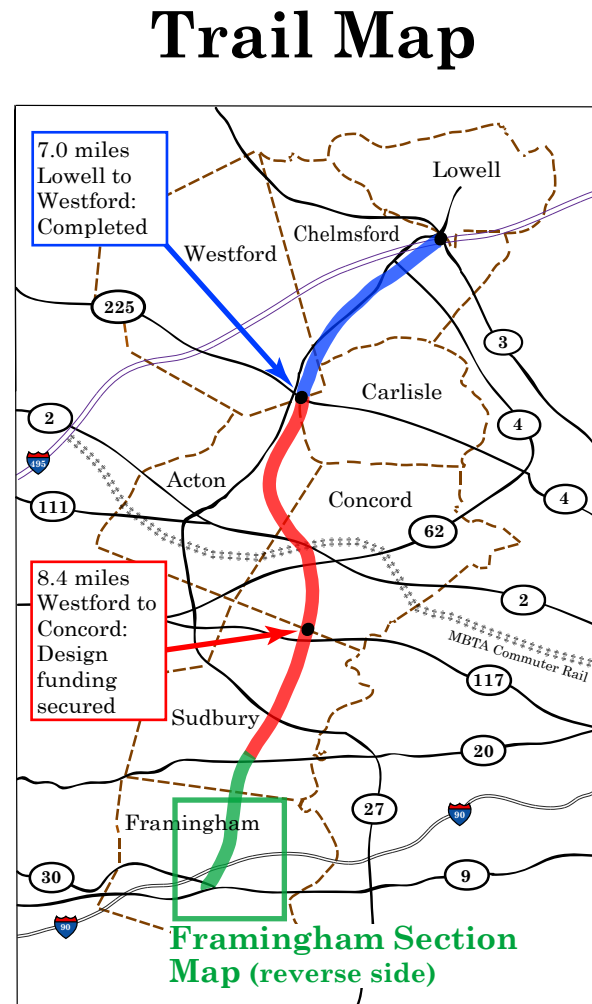

Land Transfer: Private to Public

The trail will be developed on an unused railroad right of way (ROW) owned by the CSX corporation. Negotiations are currently underway between the Town of Framingham, the Massachusetts Department of Transportation and CSX to transfer the ROW from the private to the public domain. This process will take some time, and it does have a significant cost attached to that transfer.



Do you want to see what the Framingham segment could look like?
Head north to Westford or Chelmsford to ride the completed section or take a virtual ride at: www.BruceFreemanRailTrail.org

We Need Your Help

The goals of the volunteer regional trail organization, Friends of the Bruce Freeman Rail Trail (FBFRT), are to inform the public of the community benefits of the trail and to organize public support of the trail throughout Framingham.

Your support is needed because strong public support, and partnerships between The Friends and State and Local government agencies, are essential for funding agencies to commit financial and other resources to the development of this trail.

Public support is demonstrated in many ways: attending public meetings in support of the trail, helping to clear the trail of debris and overgrowth to keep the trail open, helping with community outreach and publicity, and writing newsletters or articles to newspapers.

By joining FBFRT you will help the public realize the full vision of trail use and possibilities.

Friends of the Bruce Freeman Rail Trail
15 Chouteau Ave.
Framingham, MA 01701

This brochure generously sponsored by:

LANDRY'S BICYCLES

SINCE 1922 • LANDRYS.COM

Framingham Section

(A.K.A. The Nobscot Trail)

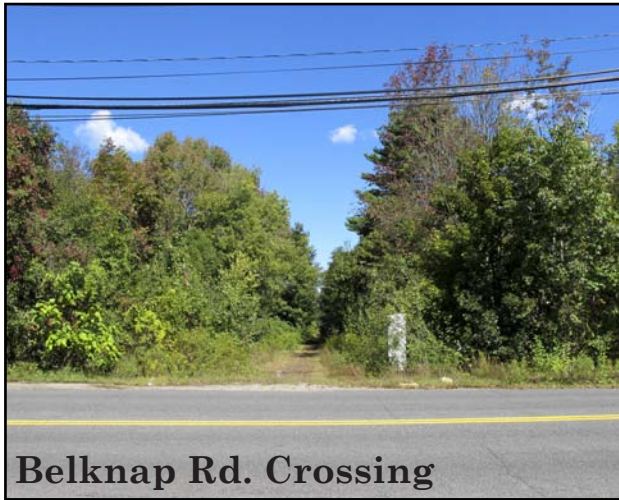
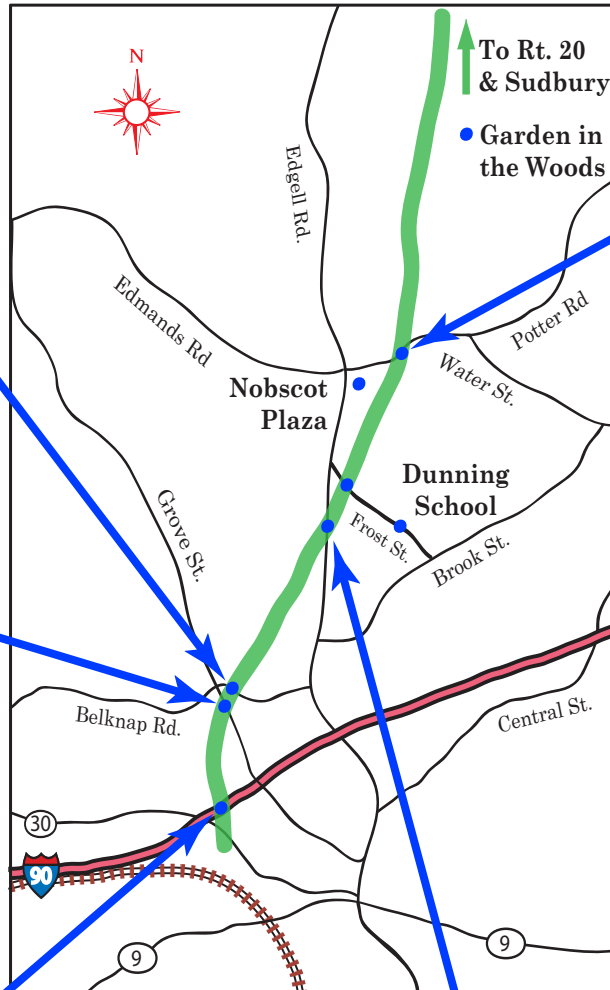

Belknap Rd. Crossing



Grove St. Trestle



I-90 Overpass



Edgell Rd. Crossing at Framingham Water Works

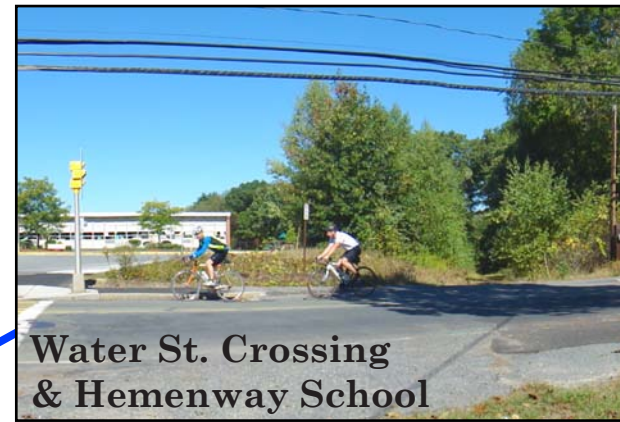

Water St. Crossing & Hemenway School

Once the trail is completed, local users will have biking and walking access to establishments on Route 9, businesses in Nobscot and Route 20 in Sudbury, Hemenway and Dunning Schools, Garden in the Woods and many of the well-established neighborhoods located all along the trail.

For More Information:
 Visit - www.BruceFreemanRailTrail.org
 E-mail - info@BruceFreemanRailTrail.org
 Contact - John Stasik (508) 877-6771
jstasik@rcn.com
 -or-
 Dawn Harkness (508) 965-8182
dawn@harkness.net

Join the FBFRT !

Yes! Sign me up as a supporter of the Bruce Freeman Rail Trail and add my name to your mailing list!

- Individual Membership \$10
- Family Membership \$25
- Sponsor* \$50
- Conductor* \$100
- Engineer* \$250
- Tycoon* \$500 and above

* Sponsor and above receive a complimentary BFBRT cap or T-shirt.

Name: _____

Address: _____

E-mail: _____

Please send newsletter via e-mail

Phone: _____

Please enclose a check payable to Friends of the Bruce Freeman Rail Trail and mail this form to:

Friends of the Bruce Freeman Rail Trail
 P.O. Box 1192
 Concord, MA 01742-1192

The Friends of the Bruce Freeman Rail Trail, Inc. is a non-profit 501(c)(3) organization. Membership fees and donations are tax-deductible to the extent permitted by law.